

FORM NO 1.

13th day of  
Elizabeth Beth.

dd.
9
3
17
3
6

South	33.3
33.9	2.4
1.7	1332
2373	666
339	79.92
37.63	
North	18.7
	35.3
South area	561
North area	935
	561
	660.11
North	94.1
8	77.6
Neat.	5646
	6587
	6587
	7302.16
	660.11
	79.92
	8042.19 N. Area

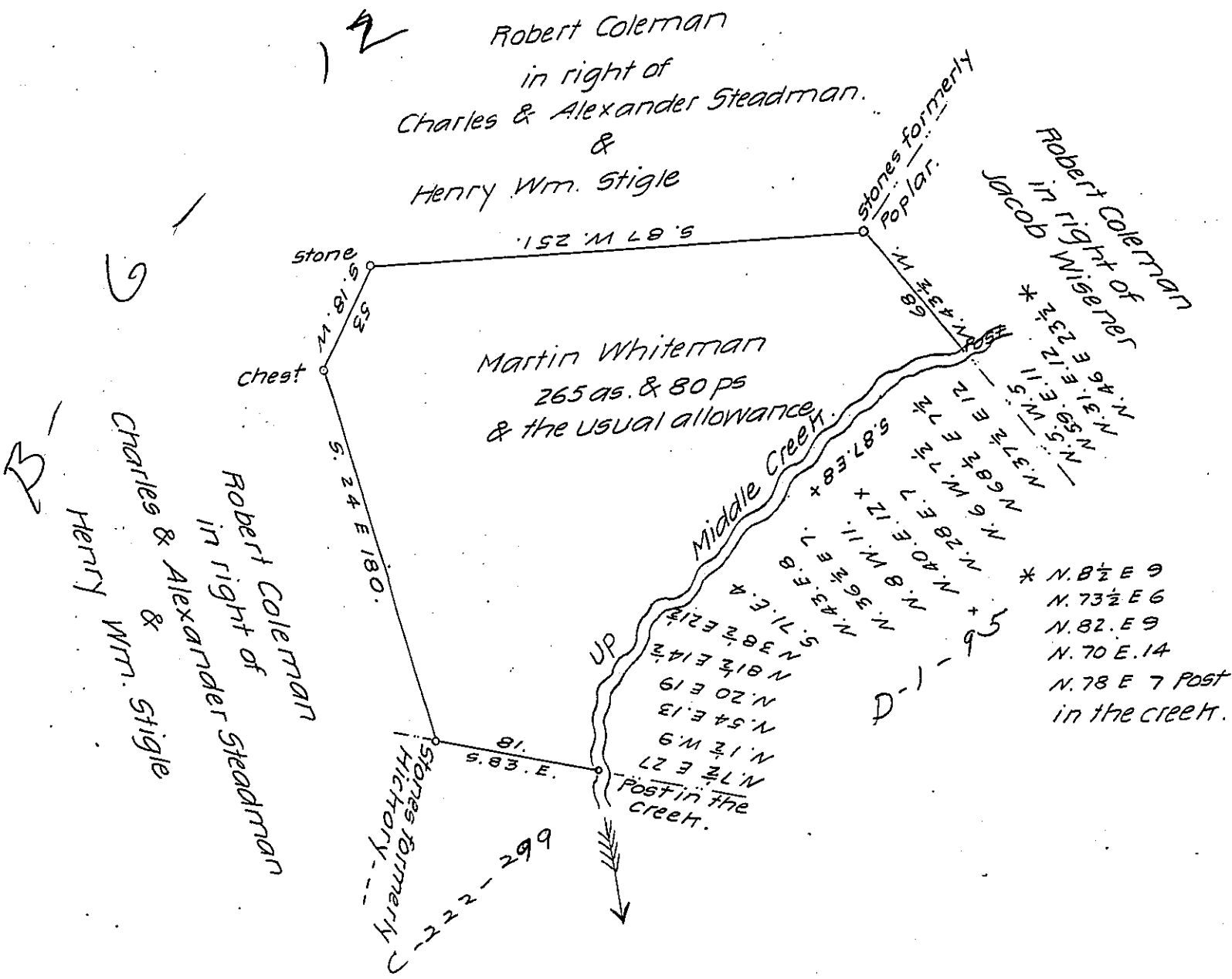

A Draught of a Tract of Land situate in Elizabeth Township,  
Lancaster County, Containing two hundred and sixty five acres and  
eighty perches & the usual allowance of six P. Cent for roads, part  
336 as. & 30 ps & the allowance by warrant dated the 13th February  
1748. Granted to Martin Whiterman surveyed the 14th day of April 1819  
for Robert Coleman Esqr. Pr.

Jacob Hibshman, D.S.

I approve of the above survey to be accepted in the Surveyor  
Generals Office December 1st. 1823.

Henry Carpenter D.S.

To Samuel Cochran Esqr.  
Surveyor General.

IN TESTIMONY that the above is a copy of the original remaining on file in  
the Department of Internal Affairs of Pennsylvania, made  
conformably to an Act of Assembly approved the 16th day of  
February, 1833, I have hereunto set my Hand and caused  
the Seal of said Department to be affixed at Harrisburg,  
this fifteenth day of September 1907

Henry Howe et al

Secretary of Internal Affairs.